

Transport and Works Act 1992  
**The Network Rail (Essex and Others Level Crossing Reduction) Order**

COUNTY OF ESSEX, DISTRICT OF UTTLESFORD

Sheet 13  
 E06 - Elsenham Emergency  
 Hut Level Crossing

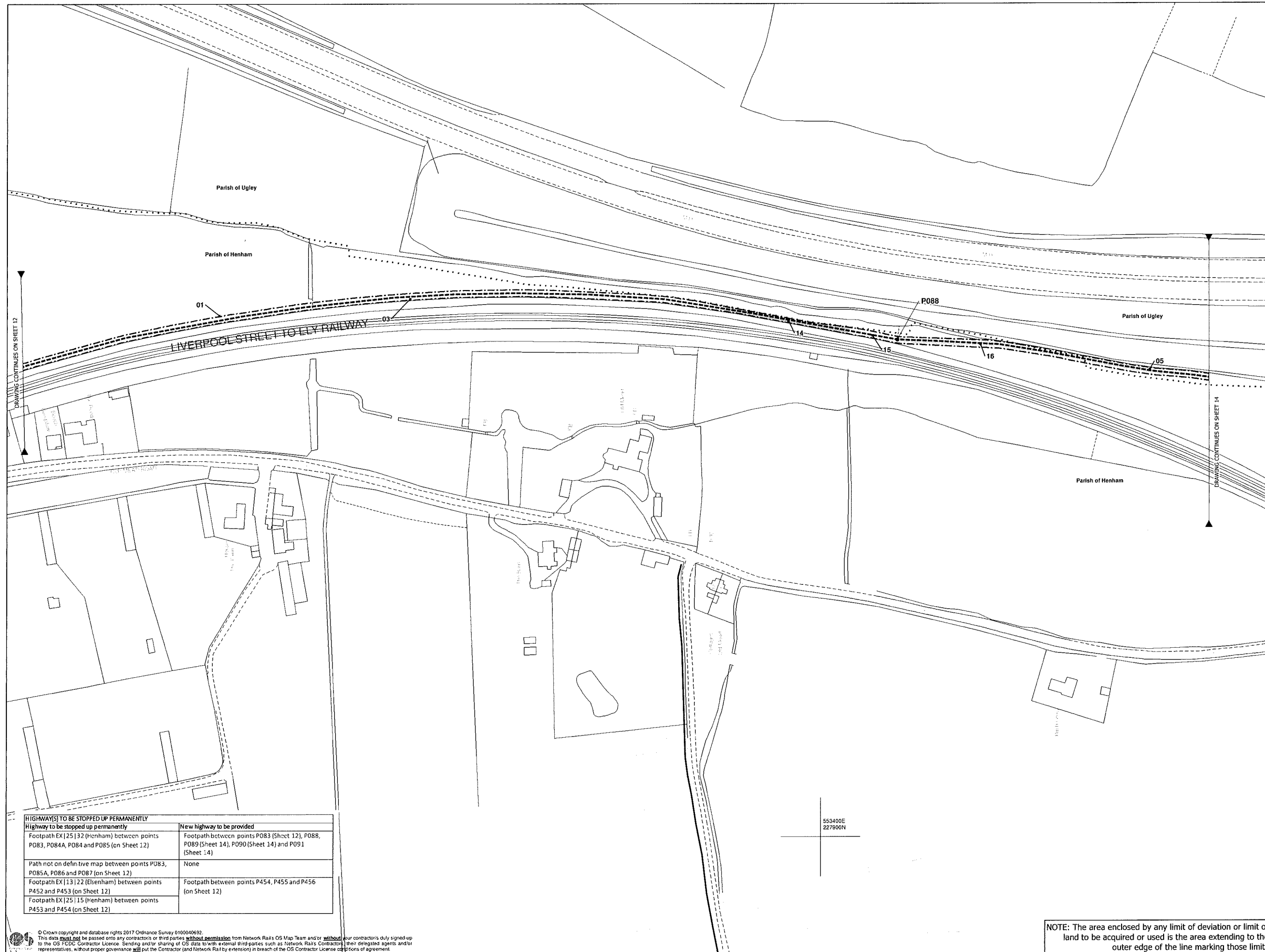

HIGHWAY(S) TO BE STOPPED UP PERMANENTLY	
Highway to be stopped up permanently	New highway to be provided
Footpath EX125132 (Henham) between points P083, P084A, P084 and P085 (on Sheet 12)	Footpath between points P083 (Sheet 12), P088, P089 (Sheet 14), P090 (Sheet 14) and P091 (Sheet 14)
Path not on definitive map between points P083, P085A, P086 and P087 (on Sheet 12)	None
Footpath EX113122 (Elsenham) between points P452 and P453 (on Sheet 12)	Footpath between points P454, P455 and P456 (on Sheet 12)
Footpath EX125115 (Henham) between points P453 and P454 (on Sheet 12)	

Unrestricted powers to acquire land No. on plan:	
Powers Limited to Temporary Use of Land and Acquisition of Rights No. on plan:	
Powers Limited to Temporary Use of Land No. on plan:	Parish of Henham 01 15 03 16 14 Parish of Ugly 05
Powers Limited to Rights No. on plan:	
Powers Limited to Extinguishment of Rights No. on plan:	

- Centreline of Work
- ⊥ Commencement of Work
- ⊥ Termination of Work
- Ⓐ New / Improved Access
- ⌈ Limit of Deviation
- ⌋ Limit of Land to be Acquired or Used
- Individual Land Parcels are shaded in contrasting shades of grey
- 01 Land Parcel Number
- ▨ Network Rail Property
- ▩ Areas of Third Party Land Benefitting from New Access Rights
- Existing or Alleged Public Right of Way
- - - New Public Right of Way
- TRAFFIC REGULATION ORDERS (IF APPLICABLE)
- ⊙ Traffic Regulation Order Reference Point
- ... Administrative Boundaries

NOTE: The area enclosed by any limit of deviation or limit of land to be acquired or used is the area extending to the outer edge of the line marking those limits.

PLAN

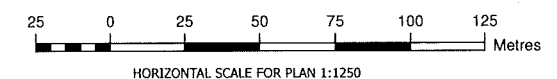

© Crown copyright and database rights 2017 Ordnance Survey 0100040692. This data must not be passed on to any contractor or third party without permission from Network Rail's OS Map Team and/or without your contractor's duly signed up to the OS FCDO Contractor Licence. Sending and/or sharing of OS data to with external third parties such as Network Rail's Contractor representatives, without proper governance will put the Contractor (and Network Rail) in breach of the OS Contractor Licence conditions of agreement.