

Transport and Works Act 1992
The Network Rail (Essex and Others Level Crossing Reduction) Order
 COUNTY OF ESSEX, DISTRICT OF UTTLESFORD

Revision Date 27-11-2018

Replacement Sheet 14
 E06 - Elsenham Emergency
 Hut Level Crossing

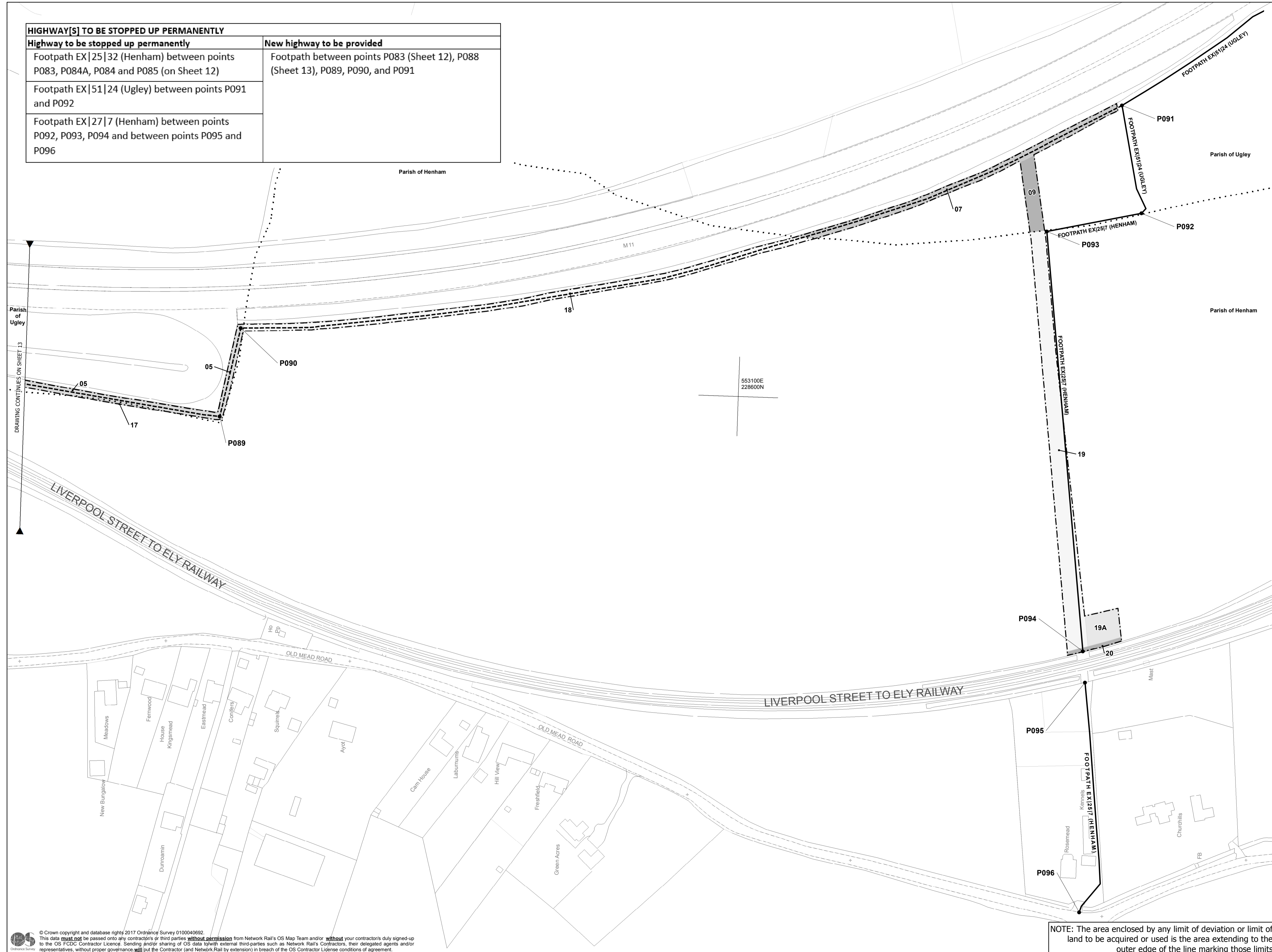

HIGHWAY[S] TO BE STOPPED UP PERMANENTLY	
Highway to be stopped up permanently	New highway to be provided
Footpath EX 25 32 (Henham) between points P083, P084A, P084 and P085 (on Sheet 12)	Footpath between points P083 (Sheet 12), P088 (Sheet 13), P089, P090, and P091
Footpath EX 51 24 (Ugley) between points P091 and P092	
Footpath EX 27 7 (Henham) between points P092, P093, P094 and between points P095 and P096	

Unrestricted powers to acquire land
 No. on plan:

Powers Limited to Temporary Use of Land and Acquisition of Rights
 No. on plan:

Powers Limited to Temporary Use of Land
 No. on plan:

Parish of Henham	
17	19A
18	20
19	
Parish of Ugley	
05	
07	
09	

Powers Limited to Rights
 No. on plan:

Powers Limited to Extinguishment of Rights
 No. on plan:

- Centreline of Work
- Commencement of Work
- Termination of Work
- (A) New / Improved Access

- [] Limit of Deviation
- [] Limit of Land to be Acquired or Used

- Individual Land Parcels are shaded in contrasting shades of grey
- 01 Land Parcel Number
 - [] Network Rail Property
 - [] Areas of Third Party Land Benefitting from New Access Rights

- Existing or Alleged Public Right of Way
- - - New Public Right of Way

TRAFFIC REGULATION ORDERS (IF APPLICABLE)

- TR01 Traffic Regulation Order Reference Point
- ... Administrative Boundaries

NOTE: The area enclosed by any limit of deviation or limit of land to be acquired or used is the area extending to the outer edge of the line marking those limits.

© Crown copyright and database rights 2017 Ordnance Survey 0100040692. This data must not be passed onto any contractors or third parties without permission from Network Rail's OS Map Team and/or without your contractor's duly signed-up to the OS FLDG Contractor Licence. Sending and/or sharing of OS data to third parties such as Network Rail's Contractors, their delegated agents and/or representatives, without proper governance will put the Contractor (and Network Rail by extension) in breach of the OS Contractor License conditions of agreement.

PLAN

