

Transport and Works Act 1992

The Network Rail (Essex and Others Level Crossing Reduction) Order

COUNTY OF ESSEX, DISTRICT OF UTTLESFORD



Replacement Sheet 14
E06 - Elsenham Emergency
Hut Level Crossing

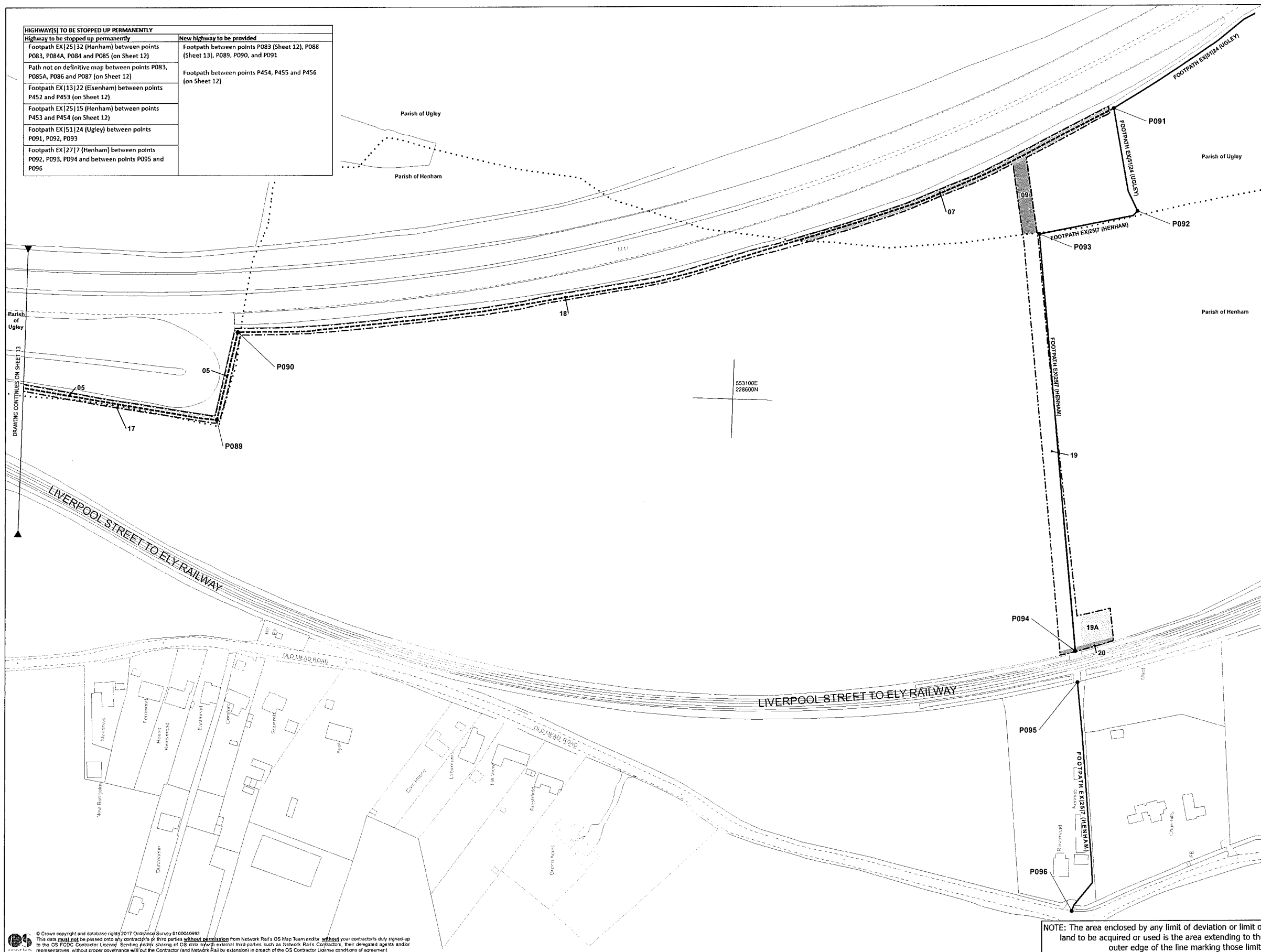

HIGHWAY(S) TO BE STOPPED UP PERMANENTLY	New highway to be provided
Highway to be stopped up permanently Footpath EX[25]32 (Henham) between points P083, P084A, P084 and P085 (on Sheet 12)	Footpath between points P083 (Sheet 12), P088 (Sheet 13), P089, P090, and P091
Path not on definitive map between points P083, P085A, P086 and P087 (on Sheet 12)	Footpath between points P454, P455 and P456 (on Sheet 12)
Footpath EX[13]22 (Elsenham) between points P452 and P453 (on Sheet 12)	
Footpath EX[25]15 (Henham) between points P453 and P454 (on Sheet 12)	
Footpath EX[51]24 (Ugley) between points P091, P092, P093	
Footpath EX[27]7 (Henham) between points P092, P093, P094 and between points P095 and P096	

Unrestricted powers to acquire land
No. on plan:

Powers Limited to Temporary Use of Land and Acquisition of Rights
No. on plan:

Powers Limited to Temporary Use of Land
No. on plan:

Parish of Henham

17 19A
18 20
19

Parish of Ugley

05
07
09

Powers Limited to Rights
No. on plan:

Powers Limited to Extinction of Rights
No. on plan:

- Centreline of Work
- ⊥ Commencement of Work
- ⊥ Termination of Work
- Ⓐ New / Improved Access
- Limit of Deviation
- ▭ Limit of Land to be Acquired or Used
- Individual Land Parcels are shaded in contrasting shades of grey
- 01 Land Parcel Number
- ▨ Network Rail Property
- ▩ Areas of Third Party Land Benefiting from New Access Rights
- Existing or Alleged Public Right of Way
- - - New Public Right of Way
- TRAFFIC REGULATION ORDERS (IF APPLICABLE)
- TR01 Traffic Regulation Order Reference Point
- ... Administrative Boundaries

© Crown copyright and database right 2017 Ordnance Survey 0100040692. This data may not be passed onto any contractor or third party without permission from Network Rail's OS Map Team and/or without your contractor's duly signed up to the OS FODC Contractor Licence. Sending and/or sharing of OS data to any external third parties such as Network Rail's Contractors, their delegated agents and/or representatives, without proper governance will put the Contractor (and Network Rail by extension) in breach of the OS Contractor Licence conditions of agreement.

PLAN

